

**TROLEX**

# ONE LIFE PROTECT IT



**TX8060**

**XKD  
ONE**

**DATA SHEET**

**UK  
CA** **CE**

Personal, real time dust exposure monitoring for industrial applications.

**P5644.1601 Rev A**

# PRODUCT OVERVIEW

## TX8060 XD One

The Trolex TX8060 XD One Personal Dust Monitor is specifically designed as a compact and robust, wearable or mountable platform to support the real-time detection, warning and logging of hazardous particulate concentrations.

With personal exposure in mind, the XD One allows users to monitor and log their immediate inhalation zones and associated risks in real-time. The device allows for body-worn, locally mountable or fixed cab installations as required.

Designed for use in a range of applications and environments, the device is suitable for monitoring both indoor and outdoor particulate conditions and is built to sense both high and low concentrations accurately. Adaptive flow rate technology supports measurement accuracy in atmospheres with varying airflow ranges.

Ease of monitoring and warning is presented through the design of a simple user interface, LED status indications and high frequency audio alarm. Devices and logged data can be reviewed, maintained and user configured via the accompanying Trolex BreatheLITE software.



# PRODUCT FEATURES

## TX8060 XD One

- Personal, Portable, Mountable Dust Monitor
- Designed for Personal Exposure Monitoring
- PM1, 2.5, 4.25 and 10 and TSP measurement range
- 0.35µm - 40µm Particle Sizing Range
- Custom Logging Intervals from 10s – 60s
- On Device Audio/Visual Alarms
- Custom Alarm Set Points (Application Configurable)
- On-Device Self Check
- Battery Operated, Rechargeable (16hrs+)
- On Device Data Logging
- Live Data Readout (Via BreatheLITE)
- Data Analytics Functions (Via BreatheLITE)
- Range of Mounting Options
- Low Maintenance
- Less than 450g



Audio/Visual Exposure Warnings

### UNRESTRICTED PARTICLE FLOW



# DATA AND CONNECTIVITY

TX8060 XD One

Connecting the XD One to the Trolex BreatheLITE application software allows for easy device navigation, set-up and custom threshold setting as required. BreatheLITE is also used to store, view and analyse your particulate exposure data from a single location and is an essential tool to support the maintenance of the XD One.

- Data Download
- Live Readings
- Device Configuration
- Device Audit Trails
- Alarm References
- Device Maintenance
- Device Reference Test
- Multiple Instruments



# TECHNICAL INFORMATION

## TX8060 XD One

### DIMENSIONS

114.5 mm  
(4.5 in)



88 mm  
(3.4 in)



74 mm  
(2.95 in)

### Specifications

### TECHNICAL INFORMATION

<b>Sensing Technology:</b>	OPC Light Scatter Photometer
<b>Particulate Measurement:</b>	0.35µm – 40µm (PM1, PM2.5, PM4.25, PM10 and TSP) Custom Particle Density Profiling
<b>Operating Temperature:</b>	-10°C to +50°C
<b>Humidity:</b>	0 - 95% RH, non-condensing
<b>Housing Material:</b>	PC/ABS – Stainless Steel
<b>Ingress Protection:</b>	Main Enclosure: IP54 Particle Flow Path: IP22
<b>Weight:</b>	445g
<b>Data Connections:</b>	1 x Mini USB (Max Cable Length 2m)
<b>Connectivity:</b>	BreatheLITE Application
<b>User Options:</b>	STEL and TWA Alarm Set Points Latching Alarms Particulate Measurement
<b>User Interface / Alarms:</b>	Visual Icon Illumination (STEL, TWA, Battery Indication) Audible (85 dB)
<b>Self Test:</b>	Sensor Hardware, Circuitry and Battery Test on Activation Manual Self Test During Use
<b>Battery Capacity:</b>	18.7 Wh Lithium Ion
<b>Battery Run Time:</b>	16hrs (Full Health at Ambient)
<b>Charging Temperature Limits:</b>	0°C to +45°C
<b>Max Charge Current:</b>	1.5A (Input Voltage 5V)
<b>Product Fixing/Mounting:</b>	Personal Mounting Clip, Klick Fast Stud, Pole Mount or Custom Bracket
<b>Certification:</b>	UKCA and CE Compliant



# ORDER REFERENCE

TX8060 XD One

## Product options:

TX8060			
Certification		Product Fixing	
General Purpose	<b>00</b>	Alligator Clip	<b>01</b>
		Klick Fast Stud	<b>02</b>

As standard, the Alligator Clip is supplied with the XD One stability strap for chest mounting.

When ordering XD One devices with the Klick Fast Stud, please also order the relevant mounting kit below.

## PRODUCT MOUNTING KITS

The XD One product mounting kits allow for Klick Fast, quick location and removal of the device for a range of mounting applications, including: Site Clothing, Belts, Direct Wall Mounting, Poles or Structures.

## Product options:

P5644		4	0		
Mounting Kit					
Body Mount	<b>01</b>				
Wall / Pole Mount	<b>02</b>				

## Alligator Clip

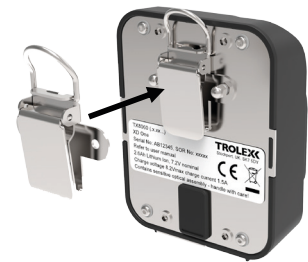

## Klick Fast Stud



## Body Mount Kit Contents



Belt Loop Dock



Sew On Dock

## Wall / Pole Mounting Kit Contents



Screw On Dock



Pole Bracket

# ORDER REFERENCE

## Compliance Pack ONE

The XD One Compliance packs allow for the regular performance checking of the device against a supplied reference particulate range.

### Product options:

<b>P5644</b>		<b>4</b>	<b>0</b>		
Compliance Pack					
Pack x 1	<b>03</b>				
Pack x 12	<b>04</b>				

The Compliance Pack ONE is available in 1 off or 12 off packs.

### Compliance Pack Contents



0.38 - 40µm Sample Range

## Cab Charger

The XD One can be installed and continuously powered using the in-cab 12-24V vehicle charger.

### Product options:

<b>P5644</b>		<b>4</b>	<b>0</b>		
Charger					
Cab	<b>05</b>				

### Cab Charger



Cab Charger

## **At Trolex, we save lives.**

We believe that no person should risk their life to earn a living.

Our aim is to become the world's leading name in health and safety technology, through pioneering products that provide real-world benefits to our customers, whenever workers operate in hazardous environments.

For more information on Trolex or if you'd like to find out more about the XD One Personal Dust Monitor please contact us at:

### **Enquiries**

[sales@trolex.com](mailto:sales@trolex.com)

### **Telephone**

+44 (0) 161 483 1435

### **Fax**

+44 (0) 161 483 5556

### **Trolex Ltd**

Newby Road, Hazel Grove  
Stockport, Cheshire  
SK7 5DY, United Kingdom

### **Website**

[www.trolex.com](http://www.trolex.com)



[trolex-ltd](https://www.linkedin.com/company/trolex-ltd)



[trolex\\_ltd](https://twitter.com/trolex_ltd)



[trolexltd](https://www.instagram.com/trolexltd)



[facebook.com/TrolexLtd](https://facebook.com/TrolexLtd)